

THIS DRAWING MAY BE USED ONLY FOR THE PURPOSE INTENDED

PLOT NO COLOURED AREA (sq m.)		REQUIREMENTS
93U	Pink 154	Title, required for Trunk Road purposes a Public Brideway
93V	Pink 419	Title, required for Private Access purposes, available for use as a Public Brideway
OWNER	Nottingham City Council Housing Dept / Chamber Estates	TENANTS
LESSSEES	Nottingham City Council Housing Dept / Chamber Estates	OCCUPIERS
93W	Green 142	Essential Licence, required for Contractor's Temporary Working Area (working area for construction of a new private means of access)
93X	Blue 71	S250 Sign to be constructed and maintain a fence
93Y	Purple 71	License to construct a Private Means of Access
OWNER	Nottingham City Council Housing Dept / Chamber Estates	TENANTS
LESSSEES	Nottingham City Council Housing Dept / Chamber Estates	OCCUPIERS
93Z	Pink 3705	Title, required for Trunk Road purposes a Public Brideway
93AA	Pink 3684	Title, required for Private Access purposes, available for use as a Public Brideway
93AB	Pink 1182	Title, required for Private Access purposes, available for use as a Public Brideway
93AC	Green 671	Essential Licence, required for Contractor's Temporary Working Area (working area for construction of a new private means of access)
93AD	Blue 142	S250 Sign to be constructed and maintain a fence
93AE	Purple 71	License to construct a Private Means of Access
OWNER	Nottingham City Council Housing Dept / Chamber Estates	TENANTS
LESSSEES	Nottingham City Council Housing Dept / Chamber Estates	OCCUPIERS
93AF	Pink 1447	Title, required for Private Access Purposes, available for use as a Public Brideway
OWNER	Nottingham City Council Housing Dept / Chamber Estates	TENANTS
LESSSEES	Nottingham City Council Housing Dept / Chamber Estates	OCCUPIERS

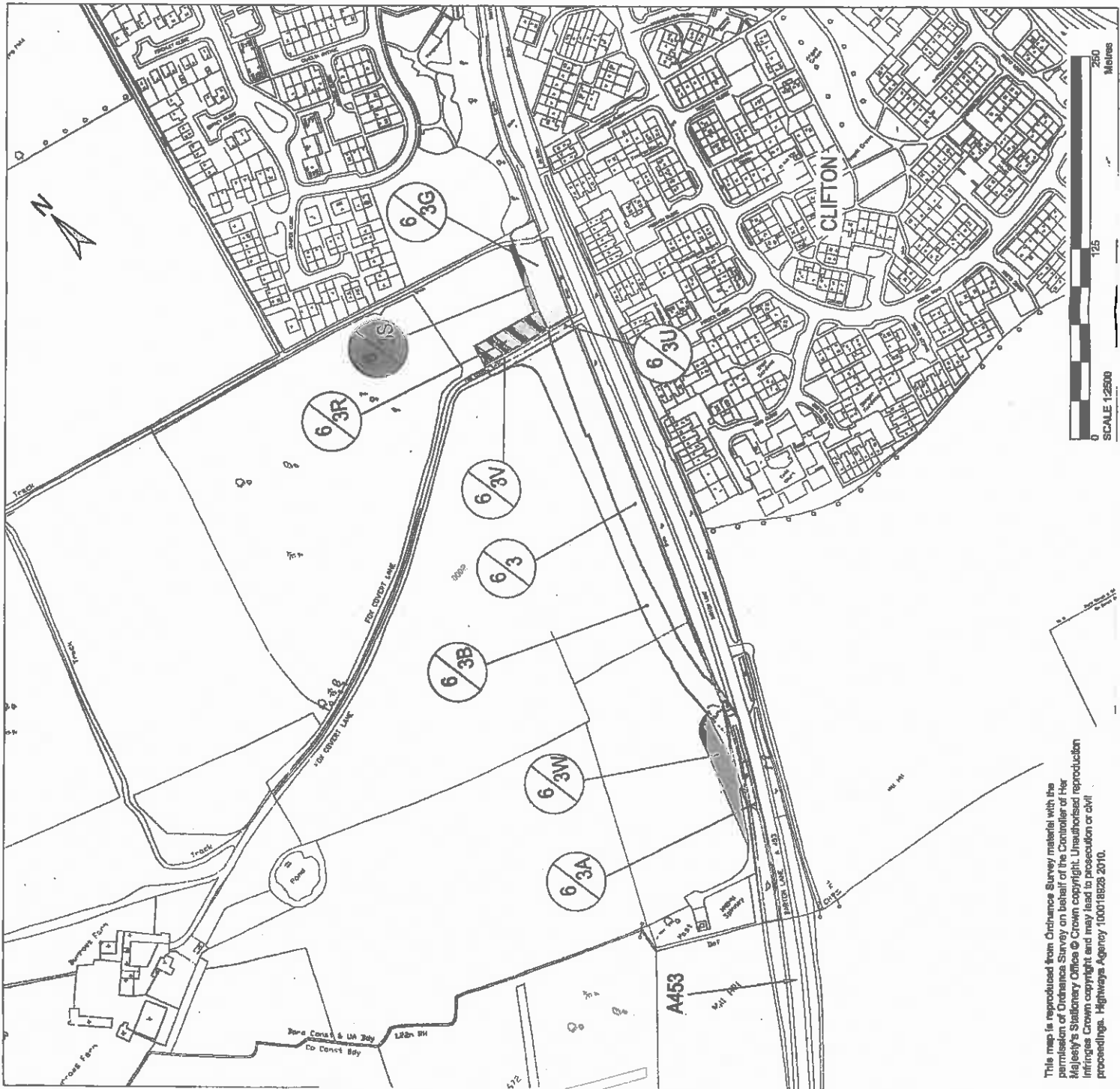

IN THE BOROUGH OF CLIFTON IN THE CITY OF NOTTINGHAM

REVISION DETAILS	BY	DATE	SUFFIX
	CHECK		

DRAWING NO. 21959/LIP/08

SCHEME TITLE
**A453 BIRMINGHAM TO NOTTINGHAM TRUNK ROAD
 (M1 JUNCTION 24 TO A52 NOTTINGHAM IMPROVEMENT)
 COMPULSORY PURCHASE ORDER (MP No. 70) 2012**

DRAWING TITLE
LAND INTEREST

This map is reproduced from Ordnance Survey material with the permission of Ordnance Survey on behalf of the Controller of Her Majesty's Stationary Office © Crown copyright. Unauthorised reproduction infringes Crown copyright and may lead to prosecution or civil proceedings. Highways Agency 100018228 2010.



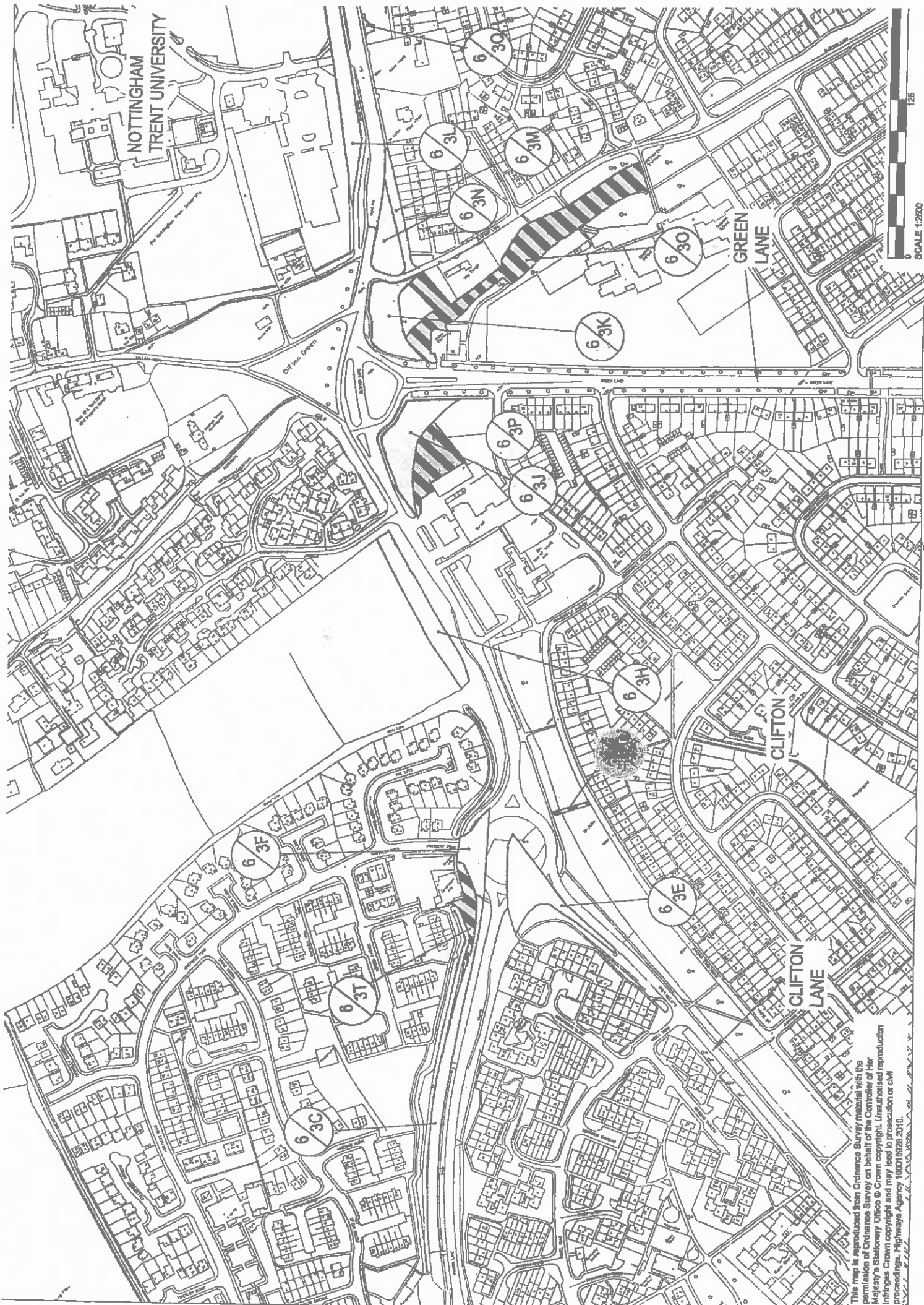

NOTTINGHAM
TRENT UNIVERSITY

GREEN
LANE

CLIFTON

CLIFTON
LANE



This map is reproduced from Ordnance Survey material with the permission of Ordnance Survey on behalf of the Controller of Her Majesty's Stationery Office © Crown copyright. Unauthorised reproduction infringes Crown copyright and may lead to prosecution or civil proceedings. Highways Agency 100018929 2010.



NOTTINGHAM
TRENT UNIVERSITY

CLIFTON

This map is reproduced from Ordnance Survey material with the permission of Ordnance Survey on behalf of the Controller of Her Majesty's Stationery Office © Crown copyright. Unauthorised reproduction infringes Crown copyright and may lead to prosecution or civil proceedings. Highways Agency 100018828 2010.

THIS DRAWING MAY BE USED ONLY FOR THE PURPOSES INTENDED	
PLOT NO	COLOURED AREA (sq. m.)
71B	28
71C	88
71D	186
71E	53
71F	65
71H	5143
71I	307
71J	140
71K	639
71L	632
71M	1069
71N	546
71O	1190
71P	688
OWNER	LESSEES
Nottingham City Council Housing Dept / Chamber Estate Lodley House Station Street Nottingham NG2 3NG	
71Q	2346
OWNER	LESSEES
Nottingham City Council Housing Dept / Chamber Estate Lodley House Station Street Nottingham NG2 3NG	
71R	1807
71S	2405
OWNER	LESSEES
Nottingham City Council Housing Dept / Chamber Estate Lodley House Station Street Nottingham NG2 3NG	

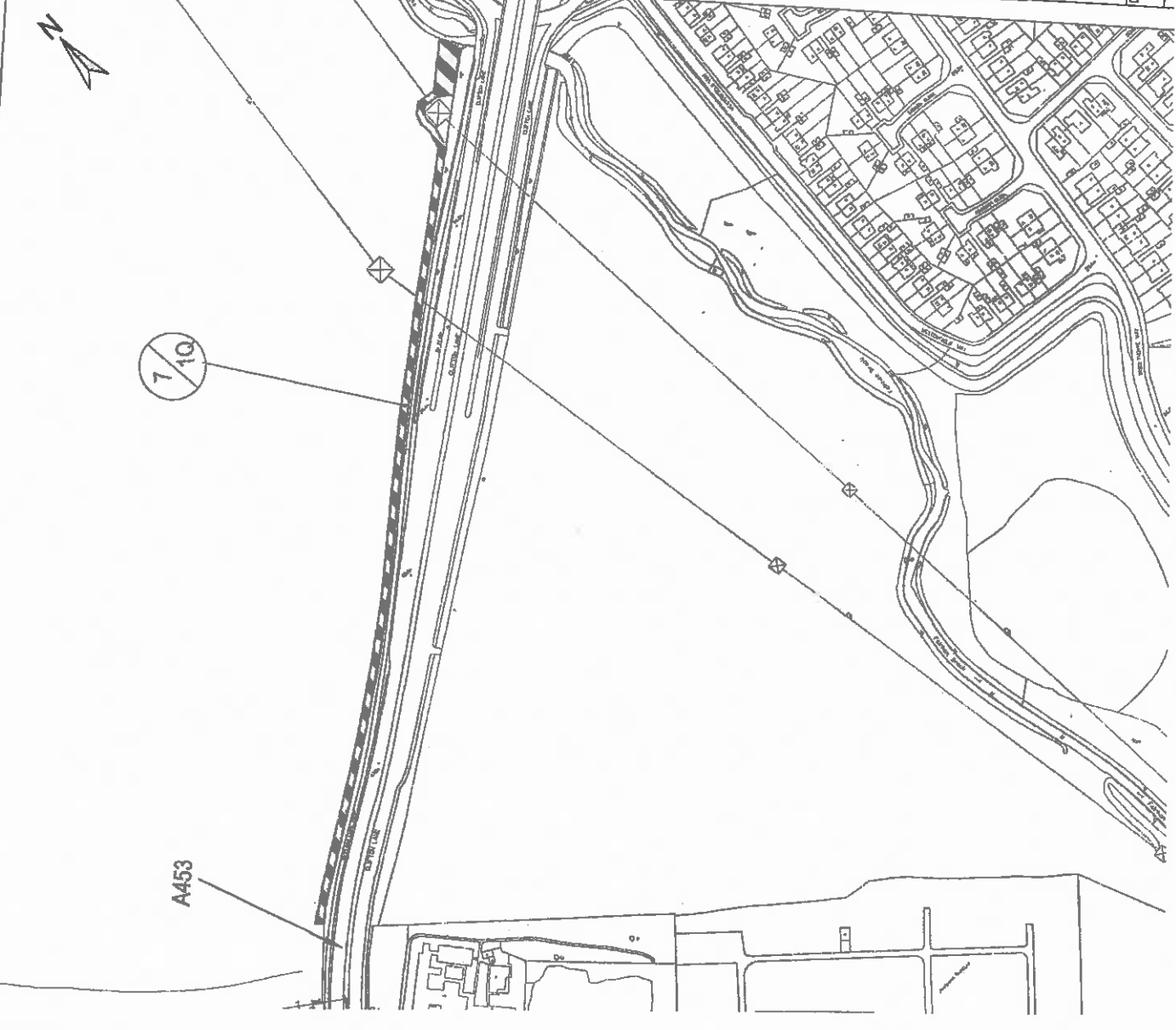

IN THE BOROUGH OF CLIFTON IN THE CITY OF NOTTINGHAM	
REVISION DETAILS	BY DATE SUPPLY
DRAWING NO.	
21959/LIP/010	
SCHEME TITLE	
A453 BIRMINGHAM TO NOTTINGHAM TRUNK ROAD (M1 JUNCTION 24 TO A52 NOTTINGHAM IMPROVEMENT) COMPULSORY PURCHASE ORDER (MP No. 70) 2012	
DRAWING TITLE	
LAND INTEREST	

