

# Appendix 1 - Floorplan

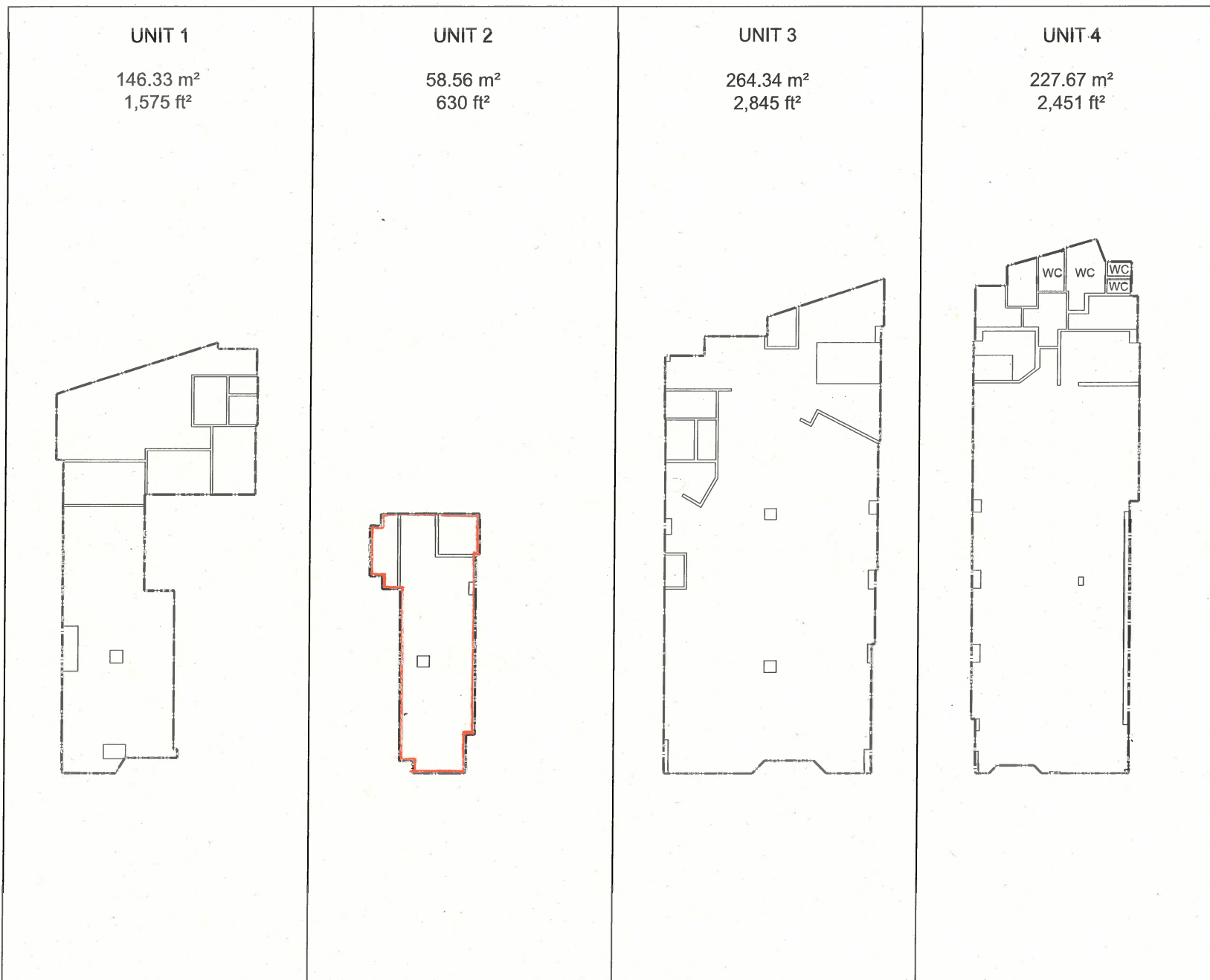

**UNIT 1**

146.33 m<sup>2</sup>  
1,575 ft<sup>2</sup>

**UNIT 2**

58.56 m<sup>2</sup>  
630 ft<sup>2</sup>

**UNIT 3**

264.34 m<sup>2</sup>  
2,845 ft<sup>2</sup>

**UNIT 4**

227.67 m<sup>2</sup>  
2,451 ft<sup>2</sup>

Revision History		
Rev	Description	Int. Date

Notes

Area Information	
<b>Net Internal Area</b>	
<b>Gross Internal Area</b>	
See inset	See inset
<b>Gross External Area</b>	

Property Address  
Fothergill House  
Nottingham

Project Title  
Project Blue

Drawing Title  
Gnd GIA (Units 1 - 4)

Date  
31/03/2015

Scale  
1:200 @ A3

Drawing No. ASL.12603

Drawn by SH

Notes:

———	Ducting
- - - - -	Net Internal Area
—————	Gross Internal Area

**armada surveys ltd.**  
St. John's House,  
St. John Maddermarket, Norwich,  
Norfolk, NR2 1DN.  
Tel/Fax: 01603 626621  
e-mail: contact@armadasurveys.co.uk

This drawing is prepared solely for the function of valuation. Site measurements have been achieved using hand held measuring devices and therefore may not be suitable for construction or design purposes. It is imperative that on-site checks are completed prior to any spatial planning, alteration or commencement of works.